

Celadon Rail System [200mm, 300mm]

Celadon Rail System: Mechanical system allowing the flexibility of multi-site wafer level reliability testing with adjustable site to site spacing

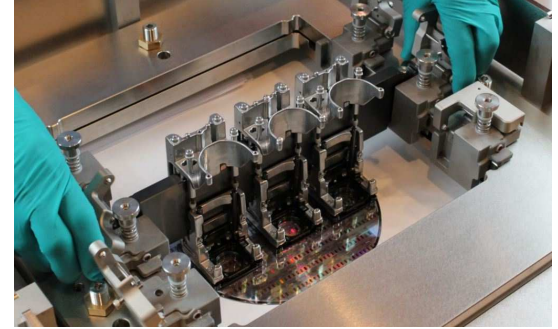

■ Features

- Multi-site testing capability with flexible die to die spacing
- Use existing TV19 VersaTiles™ to start your Celadon Rail System*
- Specialized alignment/optical tool used to align cards at temperature while maintaining your thermal environment.
- Can interface to Celadon Interface Patch Panels for channel to channel programmability, force break-outs, and interface to multiple testers.
- Interface directly to the platen of your existing prober system.
- Modular system allows addition of site assemblies over time.
- Modular system allows for sharing of site assemblies between Rail Systems
- Extreme stability of wide temperature range
- Compatible with UF200, UF300, UF3K, TEL Precio, TEL Precio Octo, TEL P8, TEL P12
- Optimized for the Cascade CM300

*Some TV19's may need to be sent to Celadon for cable rework prior to using with a Celadon Rail System

■ Specifications

Max Sites available 300mm System	22 sites max recommended
Max Sites available 200mm System	9 sites max recommended
X, Y, and Z accuracy	±5µm
Stable probing temperature range	Ambient to 300C
Probe station compatibility	Most manual, semi auto, and fully auto probers
Site Assembly Size	50mm x 60mm

- Critical Dimension

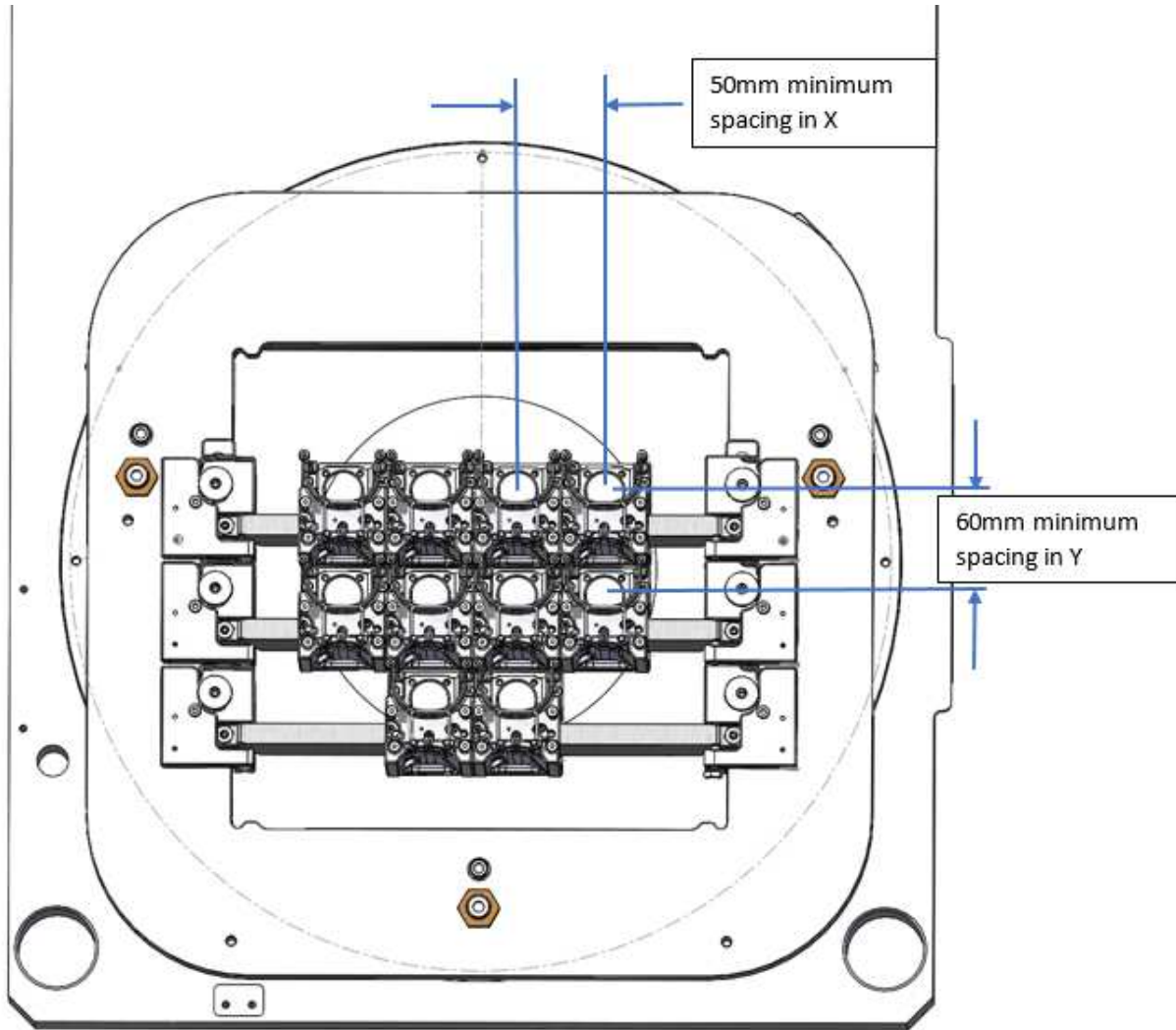

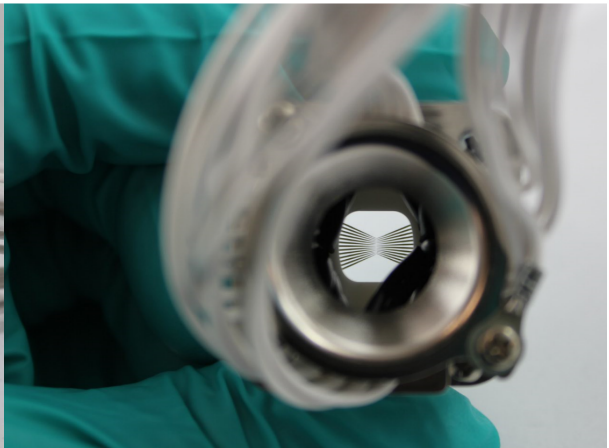
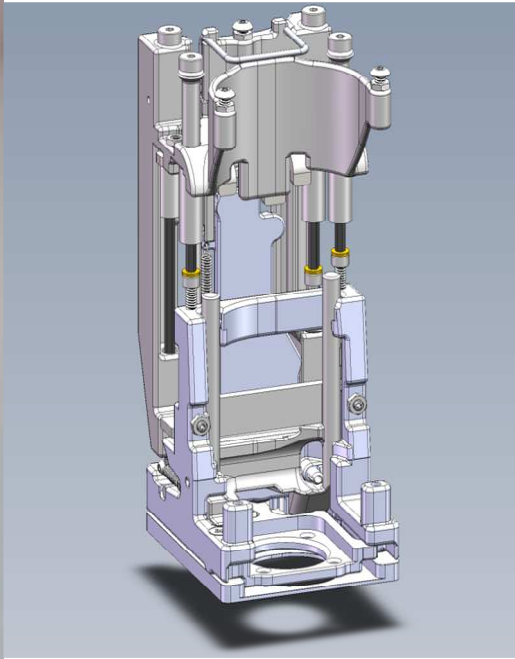

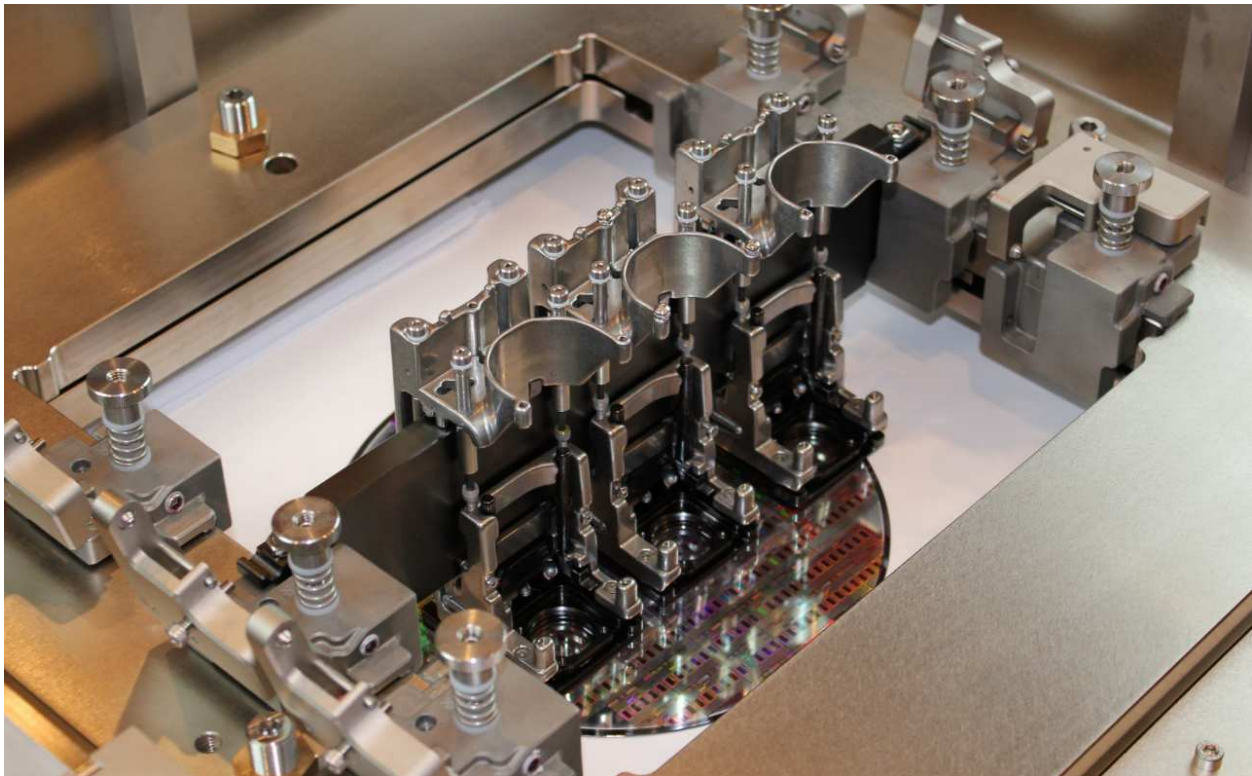

Celadon Systems, Inc.: 13795 Frontier Court Burnsville, MN 55337, USA

Phone: 952-232-1700

Fax: 952-997-6225

Web: www.celadonsystems.com

Service Requests, RFQ, Information: salesteam@celadonsystems.com

CELADON™